



## PERMEABLE PAVING SPECIALISTS

WATERPAVE IS THE INDUSTRY LEADER AND INNOVATOR IN THE CONSTRUCTION OF BONDED PERMEABLE OR PERVIOUS PAVING, SERVICING THE CIVIL, COMMERCIAL AND RESIDENTIAL CONSTRUCTION INDUSTRIES.

WaterPave now offers two permeable concrete systems: DriveCon™ and DriveTec™. Unlike 'no-fines' concrete, which has virtually no structural integrity, both WaterPave systems have been engineered to carry everyday vehicle loads, while allowing the rain water to flow through and recharge the soil below to satisfy local council permeability requirements.

## DRIVETEC™ RESIN-BONDED STONE

DriveTec™ is WaterPave's premium two-layered system, the top layer comprising of UV-stable resins mixed with granite or marble aggregates over a bonded coarse aggregate sub-base to form a strong, rigid permeable paving system. The finished product is visually similar to exposed aggregate concrete, yet smoother. This unique system has a wide range of colours available to suit all tastes.

DriveTec™ can be installed in almost any size, from the smallest paths to large commercial carparks or driveways. Different coloured patterns can also be achieved to customise a project. Adding a concrete or brick border would further enhance the end result.

### APPLICATIONS

Driveways, car parks, footpaths, tree surrounds, rooftop gardens, rear patios and side pathways, tree protection zones and water-sensitive areas where an increased level of permeability is required.

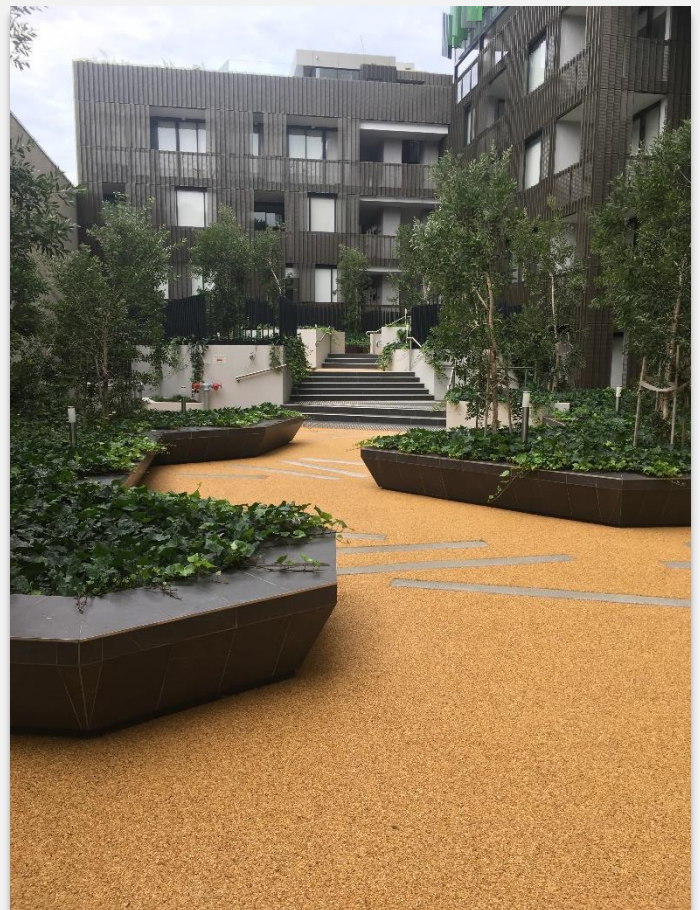

**DRIVETEC™ IN GOLD MARBLE**  
Apartment complex, Waterloo NSW

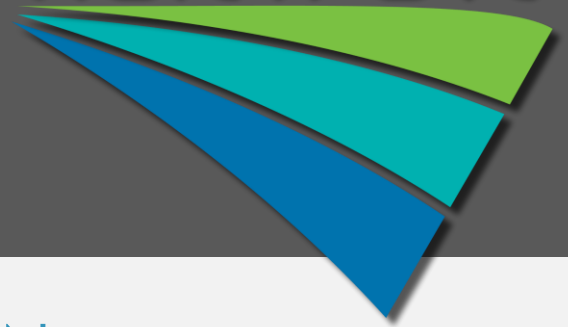

## TECHNICAL INFORMATION

- Infiltration rates when new are greater than 30L/s/m<sup>2</sup>
- Complies with Australian Standard AS 4586:2013 for Slip Resistance with a Classification of P5.
- At 120mm thick, General Mass Limits (GML) of up to 10 tonnes can be carried.

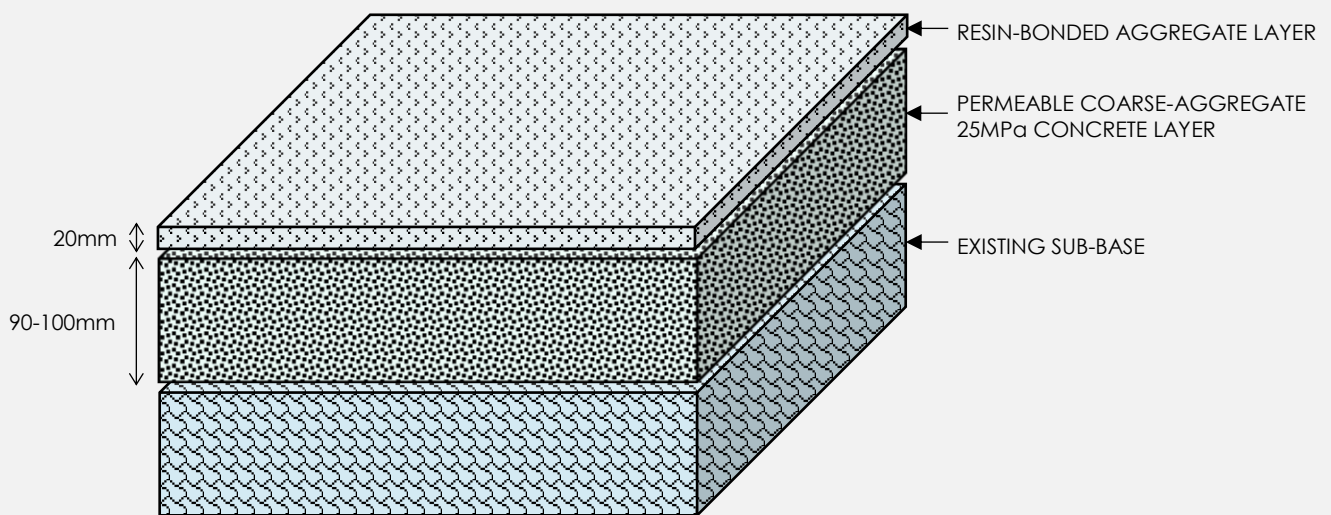

### COLOUR RANGE

We use all-natural stone, quarried and packed to order. While care is taken to correctly represent the final installed product, specifications and colours may vary without notice.



BLACK  
granite

BLUE  
marble

SILVER  
marble

STARLIGHT  
granite

SAND  
marble

GOLD  
marble

GREY  
marble

RED  
granite

### MAINTENANCE

WaterPave offers a full maintenance programme to keep its permeable paving system performing at its optimum flow rates all year 'round.